

CAST STEEL GATE VALVE FIG. 553

Cast steel Gate Valve are manufactured to the latest edition of API Standard 600 and tested to API Standard 598.

Application & Function:

Cast steel Gate valves are primarily used for stop valves fully opened or fully closed. They are not normally considered for throttling purposes, but more for slurries, viscous fluids, etc. Gate valves are characterized by a traveling wedge, which is moved with the operation of the stem nut. The wedge travels perpendicular to the direction of the flow. Gate valves usually have a minimum pressure drop when fully open, provide tight shut-off when fully closed, and remain relatively free of contamination buildup.

Accessories:

Accessories such as gear operators, actuators, bypasses, locking devices, chain wheels, extended stems and bonnets for cryogenic service and many others are available to meet the customers requirements.

Applicable Standards:

- Gate valve, API600
- Steel Valves, ASME B16.34
- Face to face ASME B16.10
- End Flanges ASME B16.5/ASME B16.47 (Raised Face With Spiral Serrated Finish Groove)
- Buttwelding ends ASME B16.25
- Inspection and test API 598

Pressure Range:

- ASME CL, 150, 300, 600, 900, 1500, 2500

Temperature Range:

- 50°C to 650°C

Size Range:

- 2" - 36"

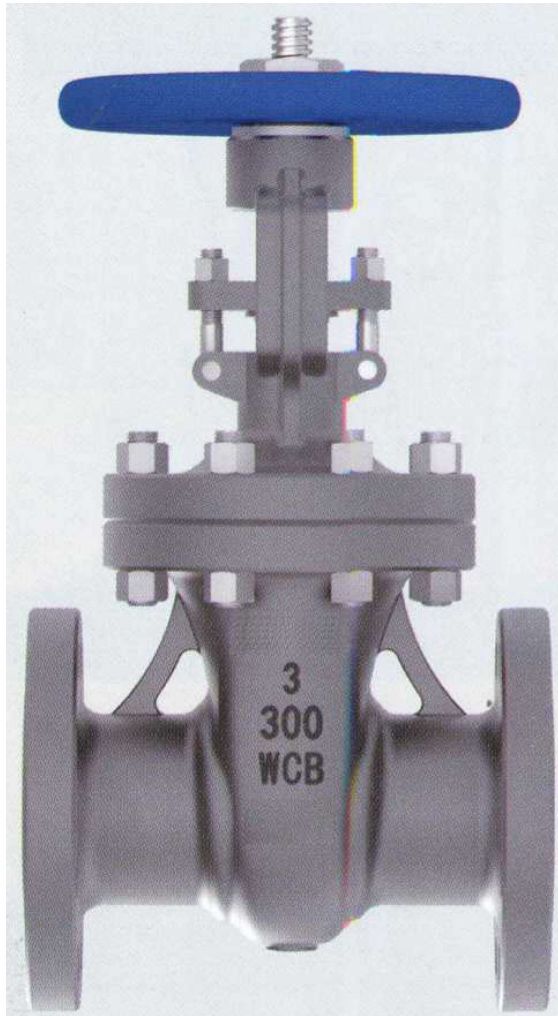

Materials

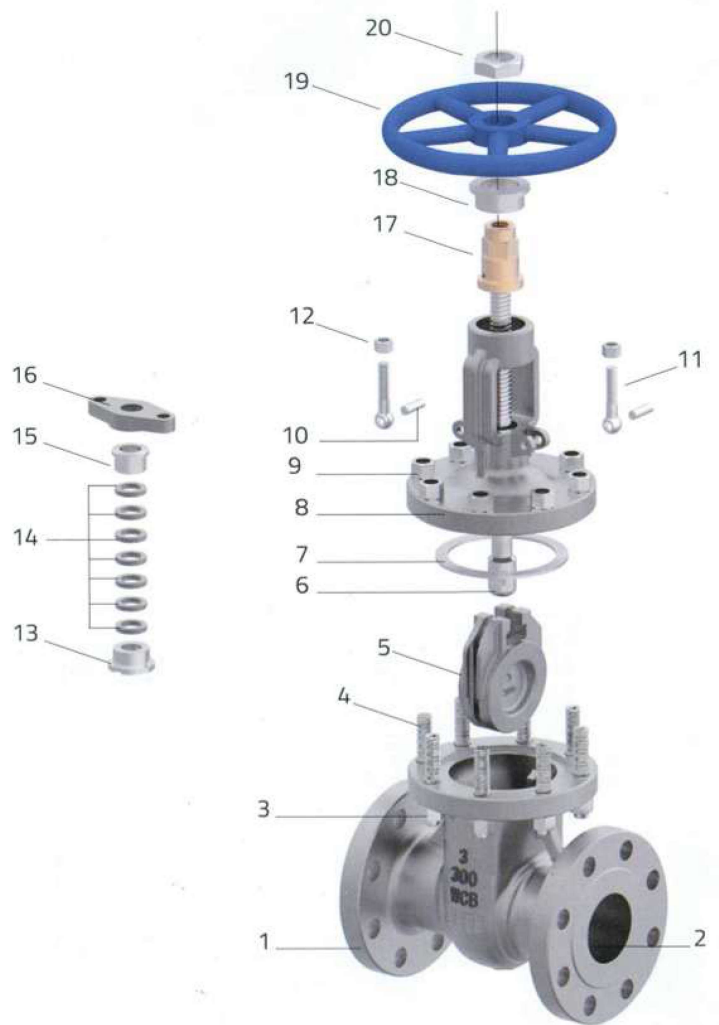

Figure: 553

Parts name	Part Name	Carbon Steel to ASTM		Alloy Steel to ASTM				Stainless Steel to ASTM				Parts name
1	Body	A216 WCB	A352 LCB	A217 WC1	A217 WC6	A217 WC9	A217 C5	A351 CF8	A351 CF8M	A351CF3	A351CF3M	1
2	Seat	A105+13Cr A182 F6a	A105+304	F11/F22+STL				304	316	304L	316L	2
3	Nuts	A194 2H	A194 4	A194 4	A194 4	A194 4	A194 4	A194 8	A194 8M	A194 8	A194 8M	3
4	Bolts	A193 B7	A320 L7	A193 B16	A193 B16	A193 B16	A193 B16	A193 B8	A193 B8M	A193 B8	A193 B8M	4
5	Disc	A216 WCB+13Cr A182 F6a	A352 LCB+304	A217 WC1+STL	A217 WC6+STL	A217 WC9+STL	A217 C5+STL	A351 CF8	A351 CF8M	A351 CF3	A351 CF3M	5
6	Stem	A182 F6a	A182 F6a	A182 F6a	A182 F6a	A182 F6a	A182 F6a	F304	F316	F304L	F316L	6
7	Gasket	SS Spiral Wound W/graphite, or SS Spiral Wound W/PTFE, or Reinforced PTFE										7
8	Bonnet	A216 WCB	A352 LCB	A217 WC1	A217 WC6	A217 WC9	A217 C5	A351 CF8	A351 CF8M	A351CF3	A351CF3M	8
9	Nuts	A194 2H	A194 4	A194 4	A194 4	A194 4	A194 4	A194 8	A194 8M	A194 8	A194 8M	9
10	Gland Eyebolt Pin	A29 1035						A276 304				10
11	Eyebolt	A193 B7	A320 L7	A193 B16	A193 B16	A193 B16	A193 B16	A193 B8	A193 B8M	A193 B8	A193 B8M	11
12	Nuts	A194 2H	A194 4	A194 4	A194 4	A194 4	A194 4	A194 8	A194 8M	A194 8	A194 8M	12
13	Backseat Bushing	A182 F6a	A182 F6a	A182 F6a	A182 F6a	A182 F6a	A182 F6a	F304	F316	F304L	F316L	13
14	Packing	Braided graphite, or Die-formed graphite ring or PTFE										14
15	Gland	A182 F6a	A182 F6a	A182 F6a	A182 F6a	A182 F6a	A182 F6a	A182 F304	A182 F316	A182 F304L	A182 F316L	15
16	Gland Flange	A216 WCB	A352 LCB	A217 WC1	A217 WC6	A217 WC9	A217 C5	A351 CF8	A351 CF8M	A351 CF3	A351 CF3M	16
17	Stem Nut	Copper alloy or A439 D2										17
18	Yoke Cap	AISI 1045	AISI 1045	AISI 1045	AISI 1045	AISI 1045	AISI 1045	A351 CF8	A351 CF8M	A351 CF3	A351 CF3M	18
19	Hand wheel	Ductile iron /Malleable Iron										19
20	H.W.Lock Nut	Carbon Steel						Stainless Steel				20

www.scivalve.com



SCI CORPORATION Co.,Ltd.
 Factory: 1/12 Moo 2, Samutsakorn Industrial Estate, Soi 7,
 Rama 2 Road, Tahsai, Muang, Samutsakorn 74000, Thailand
 Tel: (6634)440-130 Fax: (6634)440-137 E-mail: sci@scivalve.com



ISO 9001:2015
 File No.438881 QM
 ISO 14001:2015
 File No.438881 UM

Dimensions

CLASS 150

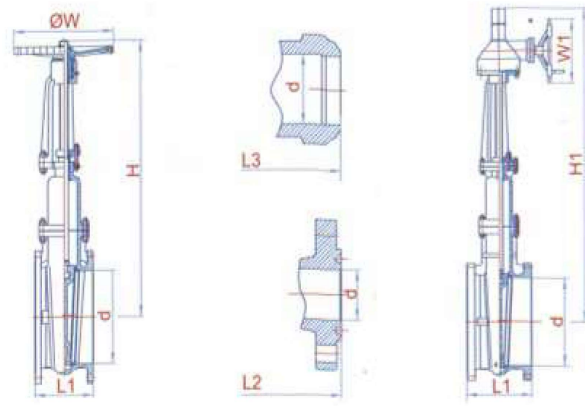

Valve Size	2"	2-1/2"	3"	4"	6"	8"	10"	12"	14"	16"	18"	20"	24"	26"	28"	30"	32"	34"	36"	
	50 mm	65 mm	80 mm	100 mm	150 mm	200 mm	250 mm	300 mm	350 mm	400 mm	450 mm	500 mm	600 mm	650 mm	700 mm	750 mm	800 mm	850 mm	900 mm	
Face to Face	L1:RF L2:RTJ L3:BW	178 191 216	190 203 241	203 216 282	229 241 305	267 279 403	292 305 419	330 343 457	356 368 502	381 394 572	406 419 610	432 445 660	457 470 711	508 521 813	559 - 864	610 - 914	610 - 914	711 - 965	711 - 1016	711 - 1016
Valve Bore(d)		50	63	76	100	150	200	250	300	336	387	438	488	590	633	684	735	779	830	874
Valve Height(H)		340	365	410	485	595	755	895	1040	1145	1333	1420	1635	1862	-	-	-	-	-	-
Valve Height(H1)		-	-	-	-	795	1015	1210	1405	1535	1780	1900	2220	2557	2680	2890	3110	3280	3500	3640
Handwheel Diameter(W)		200	200	250	280	300	360	400	450	500	500	600	700	800	-	-	-	-	-	-
Handwheel Diameter(W1)		-	-	-	-	310	310	310	460	460	460	460	530	530	530	530	600	600	600	600
Weight(Kg)	Handwheel Gear	20 -	23 -	36 -	54 -	82 104	136 150	196 215	299 315	381 451	536 597	608 651	827 863	1202 1357	- 1550	- 1880	- 2300	- 2550	- 2950	- 3390

CLASS 300

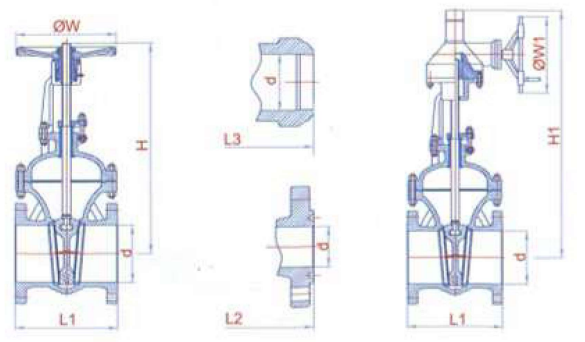

Valve Size	2"	2-1/2"	3"	4"	6"	8"	10"	12"	14"	16"	18"	20"	24"	26"	28"	30"	32"	34"	36"	
	50mm	65mm	80mm	100mm	150mm	200mm	250mm	300mm	350mm	400mm	450mm	500mm	600mm	650mm	700mm	750mm	800mm	850mm	900mm	
Face to Face	L1:RF L2:RTJ L3:BW	216 232 216	241 257 241	283 298 283	305 321 305	403 419 403	419 435 419	457 473 457	502 518 502	762 778 762	838 854 838	914 930 914	991 1010 991	1143 1165 1143	1245 1270 1245	1346 1372 1346	1397 1422 1397	1524 1553 1524	1626 1654 1626	1727 1756 1727
Valve Bore (d)		50	63	76	100	150	200	250	300	336	387	431	482	584	633	684	735	779	830	874
Valve Height(H)		364	385	460	540	649	798	940	1129	1195	1340	1503	1625	1965	-	-	-	-	-	-
Valve Height(H1)		-	-	-	650	835	1030	1255	1460	1585	1830	2000	2175	2620	2850	3080	3180	3300	3550	3760
Handwheel Diameter(W)		200	200	250	280	350	400	450	500	600	500	650	750	900	-	-	-	-	-	-
Handwheel Diameter(W1)		-	-	-	310	310	310	460	460	460	460	530	530	600	600	600	600	600	600	600
Weight(Kg)	Handwheel Gear	26 -	36 -	55 -	67 100	147 186	228 235	332 416	512 502	715 756	850 965	1100 1224	1300 1400	2200 2385	- 3000	- 3300	- 3550	- 4400	- 5200	- 6050

Figure: 553